

ROTAX 618 UL

Crankcase, Rotary Valve Drive, Water Pump

ROTAX

618 UL - 73.8 HP No Longer In Production 2 Cycle Info Pack

Part No. 999-669

73.8hp @ 6750

2 cylinder/2 stroke, liquid cooled
with rotary valve inlet

- Bore: 2.99" (76mm)
- Stroke: 2.68" (68mm)
- Displacement: 37.65 in3 (617cm3)
- Compression Ratio: th: 11.5: ef: 5.95
- Fuel: MON 85 RON 95 leaded or unleaded
- Oil: super 2-stroke motor oil
- Mixing Ratio: 50:1
- Ignition Unit: DUCATI Dual CDI
- Spark Plug: part# 897-055, BR8ES
- Generator: Performance: 200 W DC
- RPM: 6000 1/min
- Voltage: 13.5 V

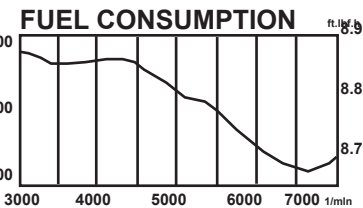
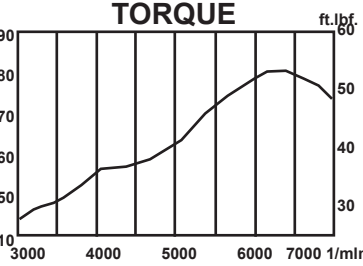
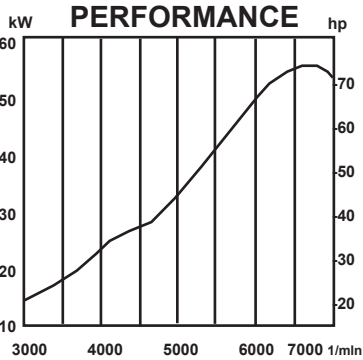

Weights

Engine	68.3 lbs.
2 Carbs	4.0 lbs.
Intake Silencer	4.2 lbs.
E Gearbox	24.7 lbs.
C Gearbox	17.6 lbs.
Exhaust System	15.2 lbs.
Generator	2.4 lbs.
Electric Starter	7.7 lbs.
Radiator 995-697	2.2 lbs.
2 Radiators, big	4.9 lbs.
Expansion Tank 922-317	0.7 lbs.
Overflow Bottle 922-325	0.4 lbs.
Oil Tank 2.4L	1.3 lbs.
After Muffler	3.5 lbs.

Dimensions given in millimeters.
To convert to inches multiply by .03937.

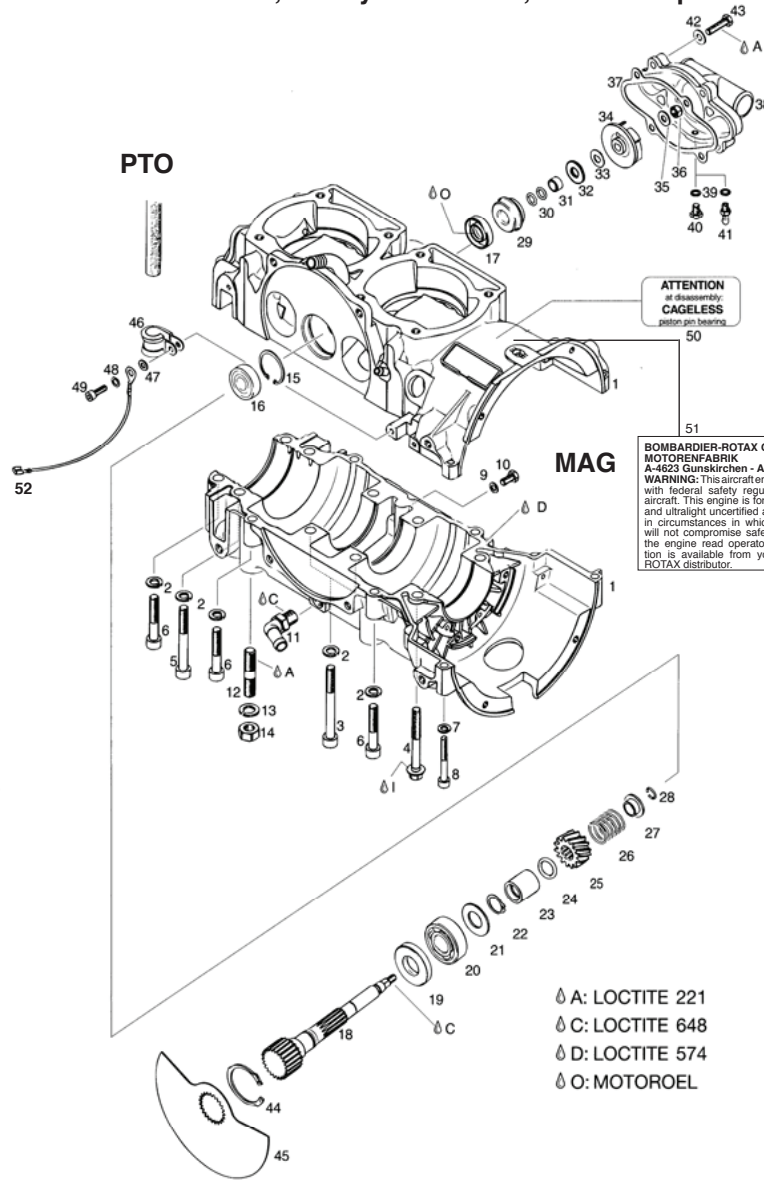

No	Description	Part No.	Qty	No	Description	Part No.	Qty
1-10	Crank Case Assembly	886-406	1	28	Circlip 12	845-160	1
2	Lock Washer A8	945-752	12	29	Rotary Seal	850-942	1
3	Allen Screw M8X75	841-831	4	30	O-Ring 8x2	430-800	2
4	Collar Hex Screw M8X65 A/F	11841-306	2	31	Rotary Seal Sleeve	847-810	1
5	Allen Screw M8X65 DIN 912	841-841	2	32	Shim 12, 1/8, 5/0, 5	944-382	1
6	Allen Screw M8X45	841-561	6	33	Friction Washer	227-155	1
7	Lock Washer A6 DIN 128	945-751	2	34	Impeller	922-036	1
8	Allen Screw M6X45 DIN 912	241-821	2	35	Washer 6.4 DIN 134	244-211	1
9	Gasket Ring A 6X10 DIN 7603	230-415	1	36	Lock Nut M6	842-042	1
10	Hex Screw M6X10	240-771	1	37	Gasket	831-616	1
11	Angular Tube 1/4-18NPT	922-245	1	38	Water Pump Housing	922-500	1
12	Stud M10X29X20	940-190	4	39	Gasket Ring 6.2X8.9X1	830-891	1
13	Lock Washer A10	945-753	4	40	Hex Screw M6X8	841-580	1
14	Hex Nut M10	242-091	4	41	Hose Nipple M6	940-557	1a
15	Retaining Ring 30X1.2	845-150	1	42	Washer 6.4 DIN 164	244-211	4
16	Ball Bearing 16101-Z	932-330	1	43	Hex Screw M6X25 DIN 933	240-036	4
17	Oil Seal A 12X30X7 NBR	850-975	1	44	Snap Ring 40X1.75	845-260	1
18	Rotary Valve Shaft	837-245	1	45	Rotary Valve 151 DEGR	924-507	1
19	Oil Seal 20X40X7	930-580	1	46	Cable Clamp 15/M5	851-250	1
20	Ball Bearing 6203 TVH C3, 17-40-12	932-032	1	47	Washer A 5.5 DIN 6902	827-800	1
21	Shim 17, 2/32, 5/1, 5	227-439	1	48	Lock Washer A5	945-750	1
22	Retaining Ring 17X1	845-450	1	49	Allen Screw M5X16	840-511	1
23	Spacer	847-282	1	50	"Cageless" Label	897-280	1
24	O-Ring 14-3	831-500	1	51	Red Warning Label	897-501	1
25	Rotary valve Gear 14T	935-735	1	52	Mass Cable Assembly	865-993	1
26	Compression Spring, 25.1MM	938-810	1				
27	Spring Holding Cup	827-430	1				

NOTE*
a - for ventilation, for engine installation with spark plugs down.

independent SERVICE CENTRE

ROTAX
AIRCRAFT ENGINES

LEADING EDGE AIR FOILS, LLC 1-800-532-3462 info@leadingedgeairfoils.com
www.leadingedgeairfoils.com store.leadingedgeairfoils.com

Initial Issue, 01/2000